

Approved	Checked	Designed	DEVELOPMENT SPECIFICATION					
		T. Tabata	P/N:LNJ818C8DRA1				TEMPORARY	
T Y P E			Orange Light Emitting Diode					
APPLICATION			Indicators					
MATERIAL			GaAsP					
OUTLINE			Attached					
ABSOLUTE MAXIMUM RATINGS			P	#1 I _{FP}	I _{FDC}	V _R	Topr	Tstg
			60	60	20	3	-30~+85	-40~+100
			mW	mA	mA	V	°C	°C
CONDITION			Ta=25±3°C					
Test Specification								
I t e m	Symbol	C o n d i t i o n	Typ	Limit		Unit		
				Min	Max			
Forward Voltage	V _F	I _F =10mA	1.93		2.6	V		
Reverse Leakage Current	I _R	V _R = 3V			10	μA		
Luminous Intensity #2	I _O	I _F =10mA DC	4.5	2.1		mcd		
Peak Emission Wavelength	λ _p	I _F =10mA DC	630			nm		
Spectral Line Half Width	Δλ	I _F =10mA DC	40			nm		
<p>#1 The Condition of I_{FP} is duty 10 % , Pulse width 1 ms</p> <p>#2 Tolerance of luminous intensity : ±20%.</p> <p>NOTE</p> <p>★1. Please contact the Panasonic local office if you design at low current (below 1mA DC) or pulse current operation and have any questions.</p> <p>★2. Soldering conditions----Refer to Handling note.</p> <p>★3. Care should be taken that soldering is done within 3-days after opening the dry package and reel.</p> <p>★4. Compositions of the lead Cu/Ni/Au plating</p>								
Nov. 7. 2001								

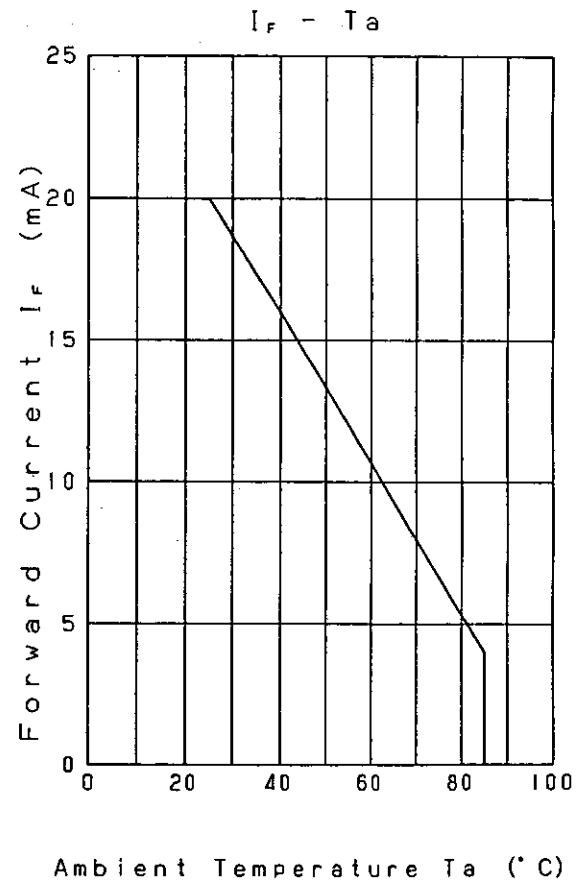
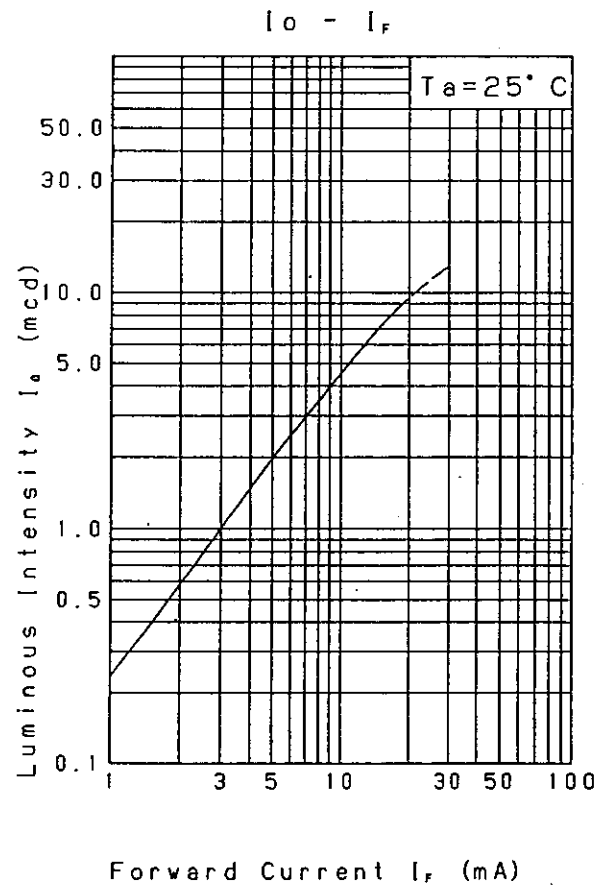
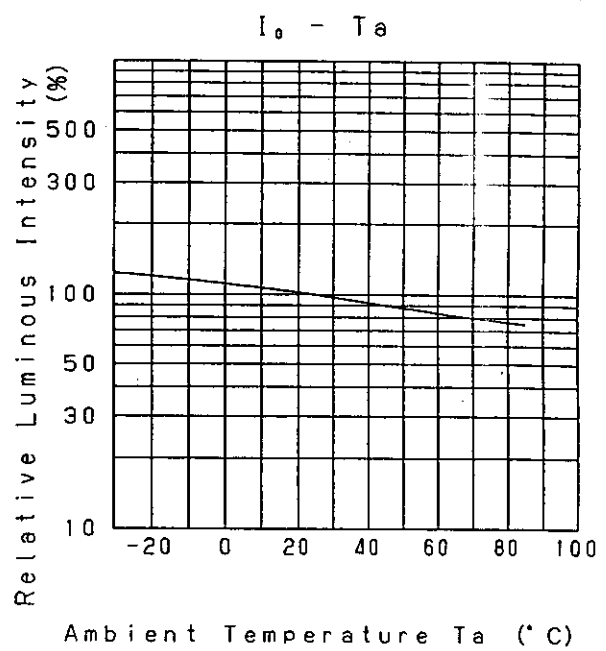
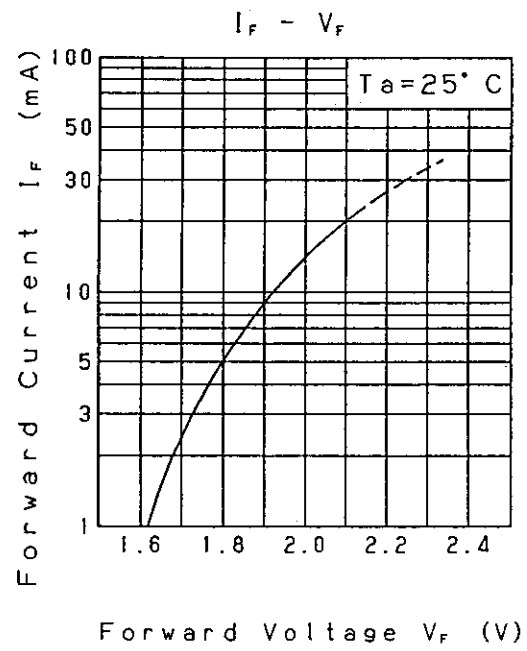

Approved	Checked	Designed
		T. Takata

DEVELOPMENT SPECIFICATION

P/N:LNJ818C8DRA1

TEMPORARY

Relative Luminous Intensity
Wavelength Characteristics

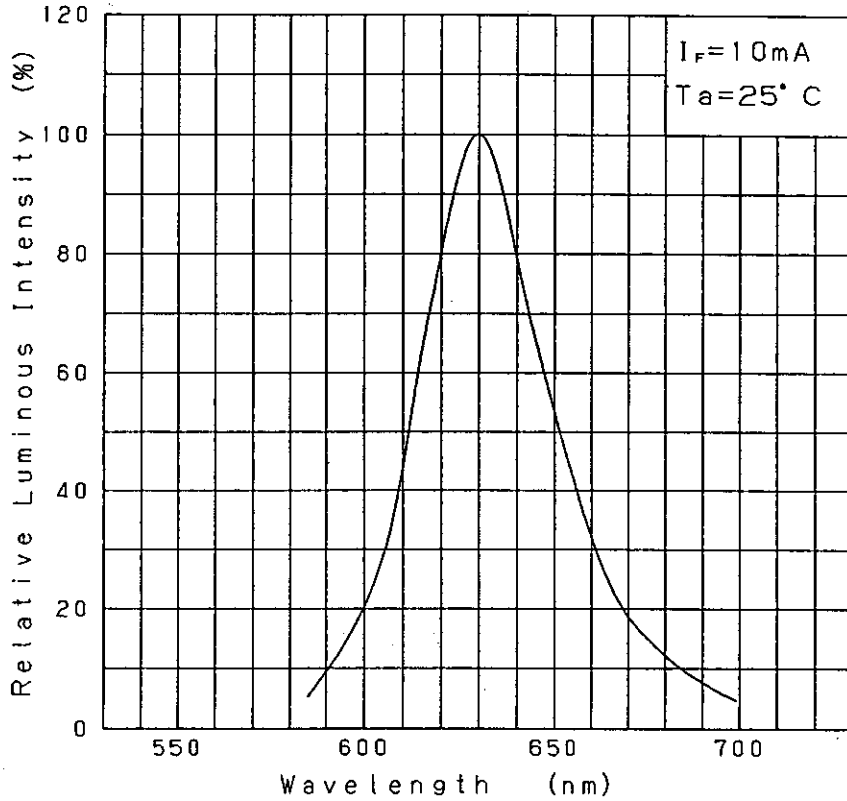

Directive Characteristics

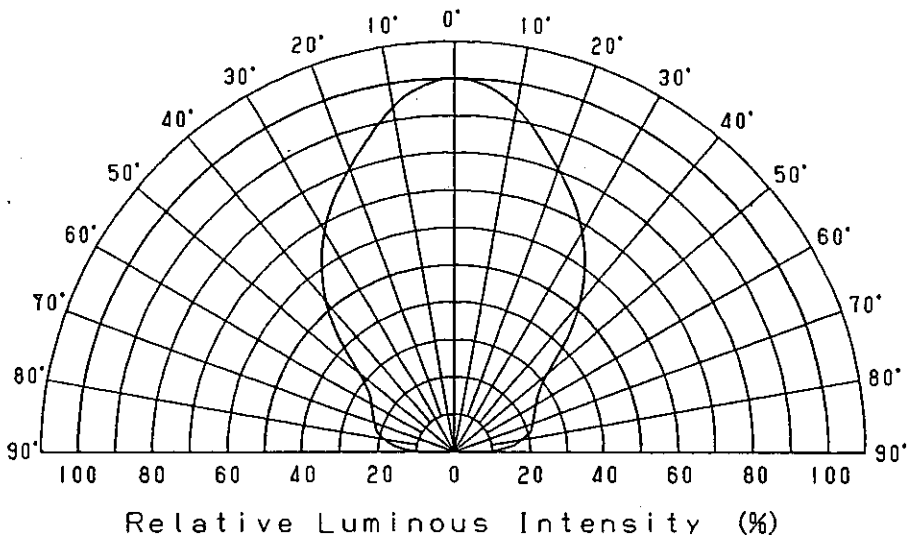

Nov. 7. 2001

Approved	Checked	Designed	DEVELOPMENT SPECIFICATION (OUTLINE)	TEMPORARY
		T. Tabata		

Outline

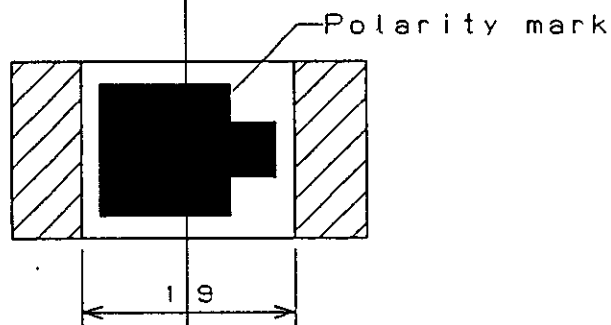
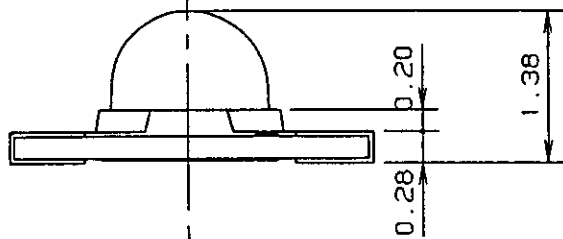
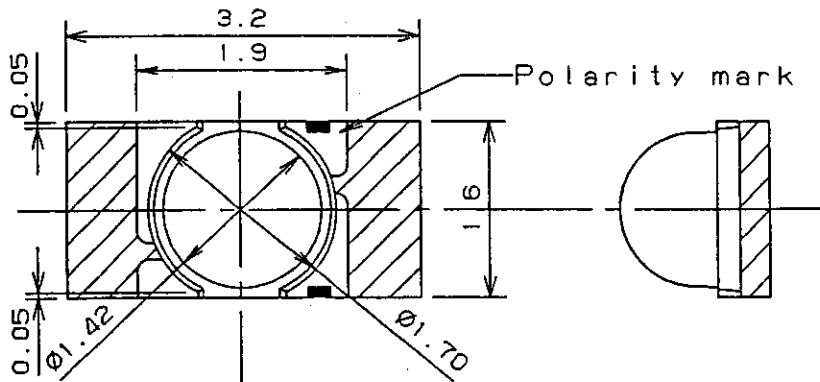

Recommended Land Layout

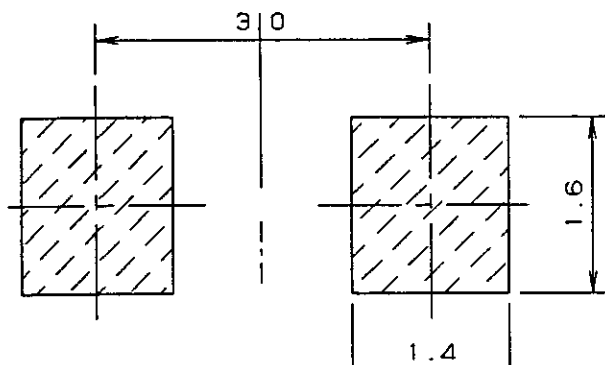

Polarity

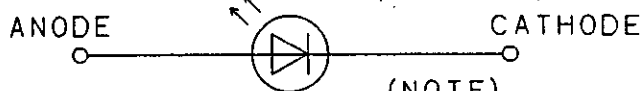

(NOTE)

1. Unit: mm
2. Tolerance unless specified is ± 0.15 .
3. indicate Au terminal.

Nov. 7. 2001			
--------------	--	--	--